

Inductors

For Power Line SMD

SLF Series SLF12555 Type

FEATURES

- The SLF series are characterized by low profile, low DC resistance, and high current handling capacities.
- Because they are magnetically shielded, these parts can be used in high-density mounting configurations.
- Flat bottom surface ensures secure, reliable mounting.
- Provided in embossed carrier tape packaging for use with automatic mounting machines.

APPLICATIONS

Portable telephones, personal computers, hard disk drives, and other electronic equipment.

SPECIFICATIONS

Operating temperature range	-20 to +90°C [Including self-temperature rise]
Storage temperature range	-40 to +90°C[Unit of products]

RECOMMENDED REFLOW SOLDERING CONDITIONS

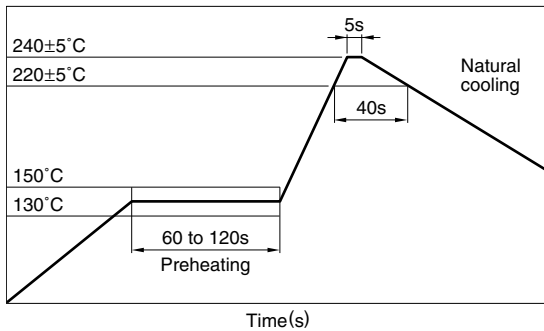

PRODUCT IDENTIFICATION

SLF	12555	T-	220	M	2R3	-2
(1)	(2)	(3)	(4)	(5)	(6)	(7)

(1) Series name

(2) Dimensions L×W×T

12555	12.5×12.5×5.5mm
-------	-----------------

(3) Packaging style

T	Taping(reel)
---	--------------

(4) Inductance value

6R0	6μH
100	10μH

(5) Inductance tolerance

M	±20%
---	------

(6) Rated current

1R9	1.9A
R88	0.88A

(7) TDK internal code

(Some products may not have this number. See the main body for details.)

PACKAGING STYLE AND QUANTITIES

Packaging style	Quantity
Taping	500 pieces/reel

Inductors

For Power Line

SMD

SLF Series SLF12555 Type

SHAPES AND DIMENSIONS/RECOMMENDED PC BOARD PATTERN

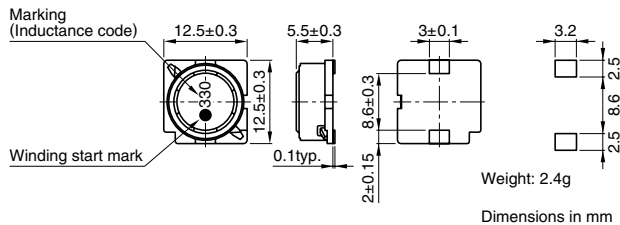

ELECTRICAL CHARACTERISTICS

Inductance (μH)	Inductance tolerance (%)	Test frequency L (kHz)	DC resistance (Ω)±20%	Rated current (A)* max.		Part No.
				Based on inductance change	Based on temperature rise	
6	±30	1	0.0164	3.6	4.9	SLF12555T-6R0N3R6
10	±20	1	0.0215	3.4	4.3	SLF12555T-100M3R4
15	±20	1	0.0259	2.8	3.9	SLF12555T-150M2R8
22	±20	1	0.0338	2.3	3.4	SLF12555T-220M2R3
33	±20	1	0.0415	1.9	3.1	SLF12555T-330M1R9
47	±20	1	0.0618	1.6	2.5	SLF12555T-470M1R6
68	±20	1	0.0832	1.3	2.2	SLF12555T-680M1R3
100	±20	1	0.117	1.1	1.8	SLF12555T-101M1R1
150	±20	1	0.19	0.88	1.4	SLF12555T-151MR88
220	±20	1	0.27	0.72	1.2	SLF12555T-221MR72
330	±20	1	0.41	0.59	1	SLF12555T-331MR59
470	±20	1	0.52	0.49	0.88	SLF12555T-471MR49
680	±20	1	0.76	0.43	0.73	SLF12555T-681MR43
1000	±20	1	1.12	0.34	0.6	SLF12555T-102MR34
1500	±20	1	1.73	0.29	0.48	SLF12555T-152MR29

* Rated current: Value obtained when current flows and the temperature has risen to 30°C or when DC current flows and the initial value of inductance has fallen by 10%, whichever is smaller.

- Test equipment L:YHP 4194A IMPEDANCE GAIN/PHASE ANALYZER, or equivalent (Measured at 1kHz/0.5V)
Rdc:MATSUSHITA VP-2941A DIGITAL MILLIOHM METER, or equivalent

TYPICAL ELECTRICAL CHARACTERISTICS

INDUCTANCE CHANGE vs. DC SUPERPOSITION CHARACTERISTICS

