

# Inductors

## For Power Line

### Radial

## ELC Series ELC0607 Type

### FEATURES

- The ELC series feature low DC resistance and high current handling capacities, making them ideal for power supply applications.
- Epoxy resin construction assures high reliability.
- Available in tape packaging to support automated mounting machines.

### APPLICATIONS

Televisions, VCRs, personal computers, and other electronic equipment.

### SPECIFICATIONS

Operating temperature range	-20 to +80°C [Including self-temperature rise]
Storage temperature range	-40 to +80°C [Unit of products]
Terminal tensile strength	14.7N min.

### PRODUCT IDENTIFICATION

ELC	0607	RA-	1R0	J	3R0
(1)	(2)	(3)	(4)	(5)	(6)

(1)Series name

(2)Dimensions

0607	7.4×6.2×10mm (lead pitch 5mm)
------	-------------------------------

(3)Packaging style (Taping products are standard.)

RA	Taping (ammo-pack)
SKI	Bulk

(4)Inductance value

1R0	1μH
120	12μH

(5)Inductance tolerance

J	±5%
K	±10%

(6)Rated current

3R0	3A
R92	0.92A

### PACKAGING STYLE AND QUANTITIES

Packaging style	Quantity
Taping(Ammo-pack)	2000 pieces/box
Bulk	1000 pieces/pack

# Inductors

## For Power Line

### Radial

## ELC Series ELC0607 Type

### SHAPES AND DIMENSIONS

#### BULK

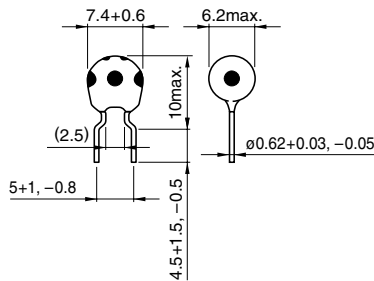

#### AMMO-PACK TAPING STYLE

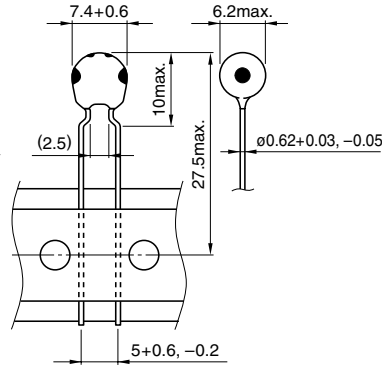

Dimensions in mm

### CHARACTERISTICS

Operating temperature range	-20 to +80°C [Including self-temperature rise, 20°C max.]
Storage temperature range	-40 to +80°C
Rated current	Based on temperature rise, 20°C
Terminal tensile strength	14.7N min.
Moisture resistance	$\Delta L/L \leq \pm 5\%$ $\Delta Q/Q \leq \pm 25\%$

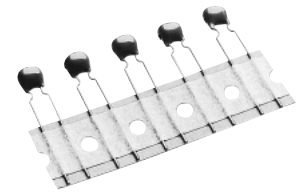

### ELECTRICAL CHARACTERISTICS

Inductance (μH)	Inductance tolerance	Q ref.	Test frequency L, Q (MHz)	DC resistance (Ω) max.	Rated current (A) max.	Part No.
1	±10, ±5%	10	7.96	0.026	3	ELC0607X*1-1R0X*23R0
1.2	±10, ±5%	10	7.96	0.029	2.8	ELC0607X-1R2X2R8
1.5	±10, ±5%	10	7.96	0.031	2.8	ELC0607X-1R5X2R8
1.8	±10, ±5%	10	7.96	0.035	2.6	ELC0607X-1R8X2R6
2.2	±10, ±5%	10	7.96	0.039	2.5	ELC0607X-2R2X2R5
2.7	±10, ±5%	10	7.96	0.041	2.3	ELC0607X-2R7X2R3
3.3	±10, ±5%	10	7.96	0.044	2.2	ELC0607X-3R3X2R2
3.9	±10, ±5%	10	7.96	0.05	2.1	ELC0607X-3R9X2R1
4.7	±10, ±5%	10	7.96	0.052	2	ELC0607X-4R7X2R0
5.6	±10, ±5%	10	7.96	0.062	1.9	ELC0607X-5R6X1R9
6.8	±10, ±5%	10	7.96	0.066	1.8	ELC0607X-6R8X1R8
8.2	±10, ±5%	10	7.96	0.08	1.7	ELC0607X-8R2X1R7
10	±10, ±5%	20	2.52	0.09	1.6	ELC0607X-100X1R6
12	±10, ±5%	20	2.52	0.1	1.5	ELC0607X-120X1R5
15	±10, ±5%	20	2.52	0.12	1.3	ELC0607X-150X1R3
18	±10, ±5%	20	2.52	0.145	1.2	ELC0607X-180X1R2
22	±10, ±5%	20	2.52	0.18	1.2	ELC0607X-220X1R2
27	±10, ±5%	20	2.52	0.22	1	ELC0607X-270X1R0
33	±10, ±5%	20	2.52	0.25	0.92	ELC0607X-330XR92
39	±10, ±5%	20	2.52	0.31	0.88	ELC0607X-390XR88
47	±10, ±5%	20	2.52	0.35	0.77	ELC0607X-470XR77
56	±10, ±5%	20	2.52	0.42	0.72	ELC0607X-560XR72
68	±10, ±5%	20	2.52	0.45	0.63	ELC0607X-680XR63
82	±10, ±5%	20	2.52	0.57	0.61	ELC0607X-820XR61
100	±10, ±5%	20	0.796	0.69	0.55	ELC0607X-101XR55
150	±10, ±5%	30	0.796	1.1	0.44	ELC0607X-151XR44
220	±10, ±5%	40	0.796	1.7	0.36	ELC0607X-221XR36
330	±10, ±5%	50	0.796	2.5	0.29	ELC0607X-331XR29
470	±10, ±5%	60	0.796	4.1	0.23	ELC0607X-471XR23

\*1 X: Please specify packaging style, SKI(Bulk) or RA(Taping).

\*2 X: Please specify inductance tolerance, K(±10%) or J(±5%)

• Test equipment Inductance, Q: YHP4194A IMPEDANCE/GAIN-PHASE ANALYZER  
DC resistance: MATSUSHITA VP-2941A DIGITAL MILLIOHM METER

# Inductors

For Power Line  
Radial

## ELC Series ELC0607 Type

### TYPICAL ELECTRICAL CHARACTERISTICS INDUCTANCE CHANGE vs. DC SUPERPOSITION CHARACTERISTICS

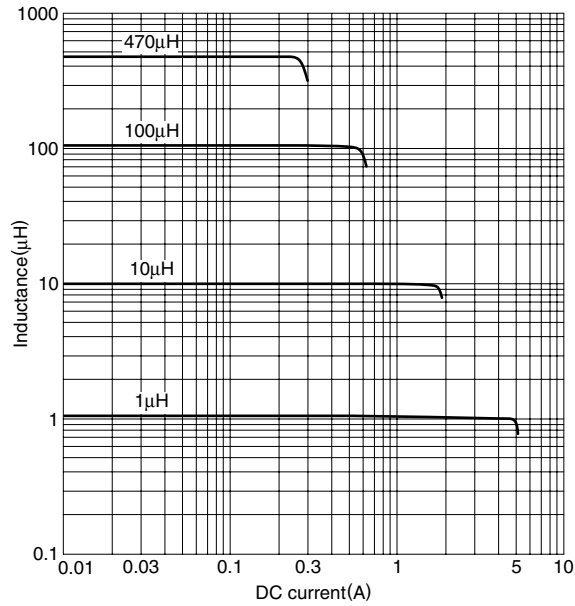

### ATTENUATION vs. FREQUENCY CHARACTERISTICS

